

# use instruction

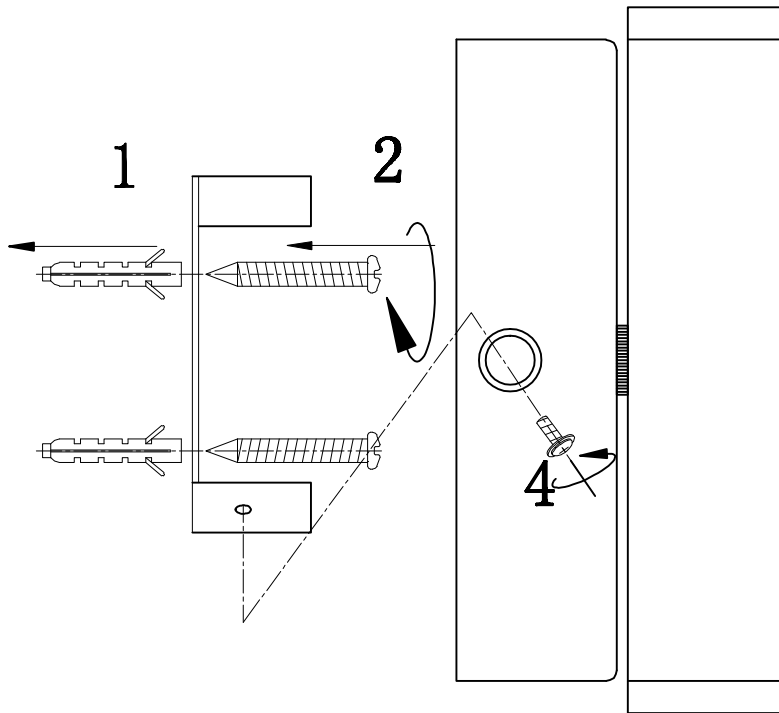
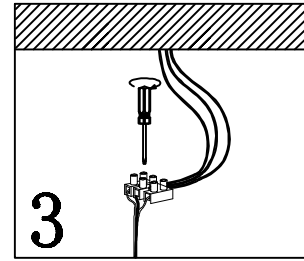

## NOTE:

1: This lighting only can be used in room.  
2: Do not turn switch on before Assembly.

3: If you want to change bulb, please turn switch off, and after the bulb is cold.

Voltage: 220-240V

Bulb: 2\*4.8W

Burner: LED

Frequency: 50/60Hz

## Maintenance and repair

In order to use this product for long, please clean it every month one time. Please use only fine glass cleaner and soft rag to clean the surface always unplug it before cleaning.

## Warning:

Do not use gasoline, alcohol to clean it, because it will destroy it.

**Model: 2113-1W**